

# LINEAR FLOOR DRAIN

---

## INSTALLATION GUIDE



# LINEAR FLOOR DRAIN INSTALLATION GUIDE

## I. USES

The Linear Floor Drain has been developed specifically for concrete or screeded floors and can be used on concrete slabs, planks and block and beam floors.

The key feature of the Linear Floor Drain is its height - the total height from the base to the top of the trough being only 55mm.

### Key Features

- Overall height 55mm (min) including trap
- BBA approved
- Lifetime Guarantee
- 360° rotatable waste position
- Waterless trap
- Flow rate up to 29 L/min single trap or 50 L/min double trap
- Height adjustable drain body
- Height adjustable grill
- Easy to clean and replace trap

making it perfect for today's modern construction methods. The drain incorporates a unique waterless trap which has a lifetime guarantee and has been granted BBA approval.

It is available with one or two traps and a choice of stylish grill finishes.

## 2. ELEMENTS

The Linear Floor Drain consists of the following:

- Single or double outlet linear drain
- Waterless trap
- Height adjustable Stainless Steel Grill

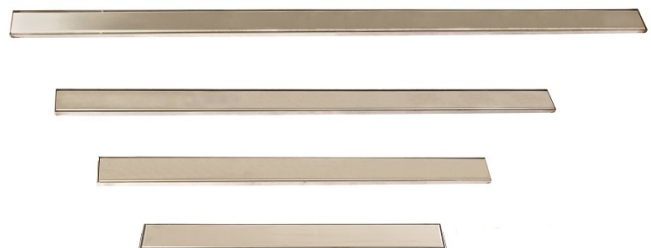

# LINEAR FLOOR DRAIN INSTALLATION GUIDE

## 3. APPLICATION - A STEP BY STEP GUIDE

1. Consider the position of the drain within the floor and mark accordingly

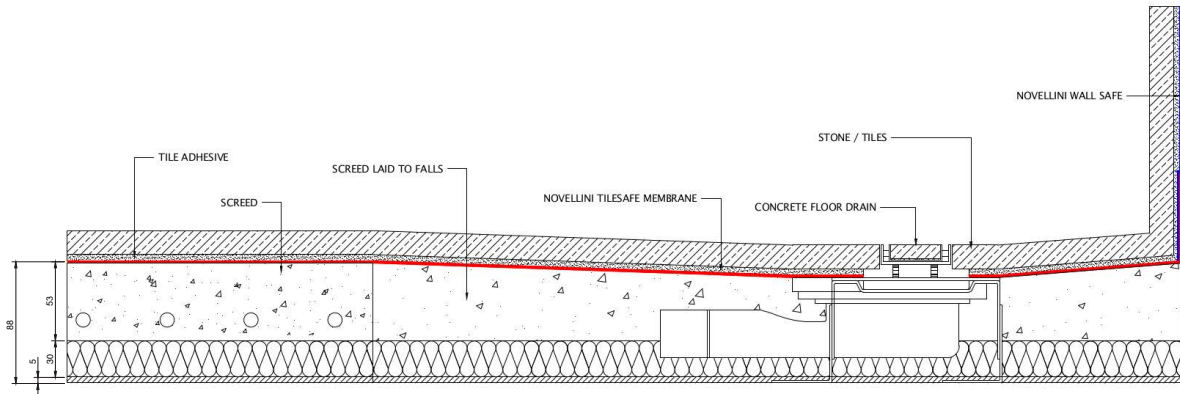

2. Adjust the rotatable outlet to the required position.

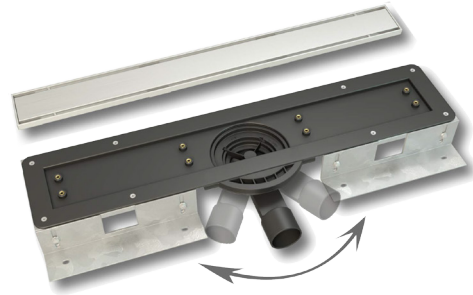

3. When the drain is in the correct position secure the legs to the sub-floor with appropriate fixings. Use the additional rear fixing brackets to secure the legs closest to the floor. Set aside the stainless steel grill and frame for later use.



4. Loosen the 8 bolts and set the height of the drain approximately 12-15mm lower than the height of the screed to allow for a fall to be created when the screed is laid.

Once the height is set, tighten the 8 bolts ensuring that the drain is set level from left to right and back to front

Remember to ensure that the screed is packed under and around the drain body ensuring that the drain is set level from left to right and back to front.



# LINEAR FLOOR DRAIN INSTALLATION GUIDE

5. For double trap drains there is two end brackets and one centre bracket:



6. Connect the trap[s] to the waste pipe. Mask the top of the drain to prevent debris entering the trap when the screed is laid.
7. The screed can now be laid to fall within the shower area [see diagram below].

Remember to ensure that the screed is packed under and around the drain body ensuring that there are no voids and that the drain is fully supported.

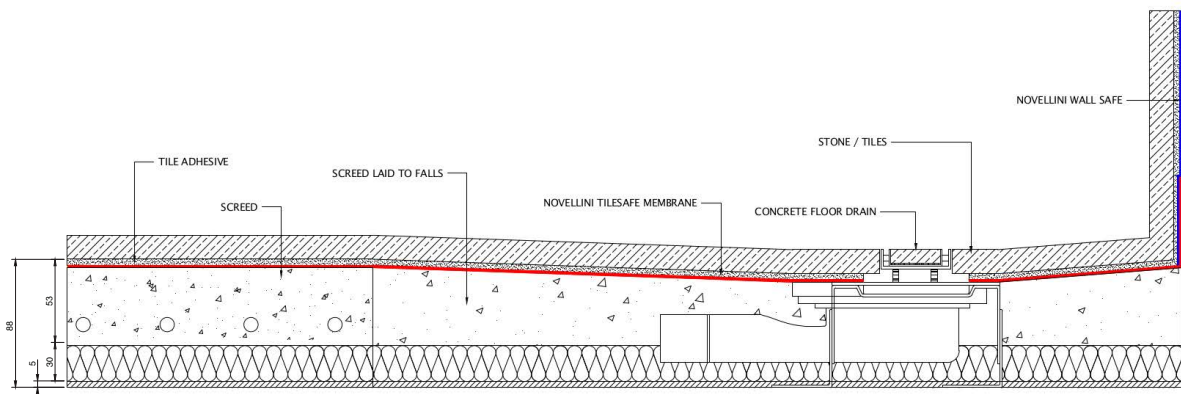

8. Once the screed is dry, the area is then ready for the the Novellini floor and wall membrane to be installed.

Remember to clean the trough with the alcohol wipe supplied, prior to installing the floor membrane.

**NOTE:** For full details see separate installation instructions.

After the floor membrane has been installed, fit the Linear Grill and adjust as necessary, following separate instructions supplied.

## For Grill lengths over 600mm

Ensure the solid ends of the frame are fully supported with tile adhesive, if the overhanging frame is not supported it may distort and need to be replaced.

Tiling - ensure that rapid-set, waterproof, flexible adhesive and grout are used to fix and finish your tiles.

# LINEAR FLOOR DRAIN INSTALLATION GUIDE

## 4. TYPICAL FLOOR BUILD UP

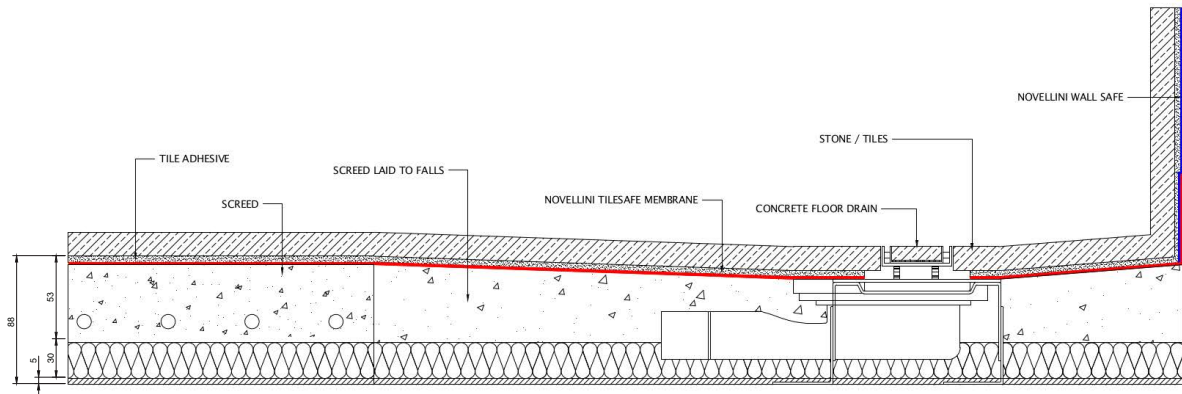

# LINEAR FLOOR DRAIN INSTALLATION GUIDE

## 5. IMPORTANT NOTES

- Ensure that the screed is packed under and around the drain body taking care that there are no voids and that the drain is fully supported.
- Always use the alcohol cleaning wipe to de-grease and clean the drain body prior to the installation of the membrane.
- Ensure that the flow rate of the shower does not exceed 29 L/min for single trap or 50 L/min for the double trap drain.
- The waterproof membrane should cover the entire shower area and a minimum of one metre beyond in either direction.
- Ensure the correct length bolts are used to secure the stainless steel frame to the drain body. Only use the longer bolts when using the larger spacing washers.
- Do not over tighten the fixing bolts as this may damage the trough.
- The waterless trap can be removed by carefully lifting it out of the drain body:

When replacing the it, use a rocking motion to re-seat it correctly back into the drain body.



- Always tile using a water resistant C1 or C2 cementitious tile adhesive, meeting the requirements of BS EN 12004. Tile grout should be water resistant, meeting the requirements of BS EN 13888.
- Tiles in wetrooms should be fixed using the solid bed method, i.e. ensuring that there are no voids beneath the tiles.

# LINEAR FLOOR DRAIN INSTALLATION GUIDE

---

TECHNICAL HELPLINE  
CALL: 01256 766757



UK Head Office  
Novellini UK Ltd  
Unit 11 Caxton  
Court Porters  
Wood St Albans  
Hertfordshire  
AL3 6XT

Telephone: 01727 229922  
Fax: 01727 838232

e: [info-uk@novellini.com](mailto:info-uk@novellini.com)  
[www.novellini.com](http://www.novellini.com)